

Luna-Lite

40W LED Panel Light Specification



Parameters

Product Model	YHL-PL3-40
LED Chip Brand	Nichia
Light Efficiency	130 lm/W
Luminous Flux	4200 lm
Color Temperature	4500 ~ 5500K(2500 ~ 5500K optional)
Beam Angle	110°
Total Power Consumption	40W±3W
Output Current	1020mA (constant current)
Output Voltage	DC 30 ~ 36V
Net Weight	4.0kg±0.2kg
Light Dimensions	L595mm×W595mm×H68mm
Light Package Dimensions	L645mm×W645mm×H400mm(3pcs)

Light Distribution

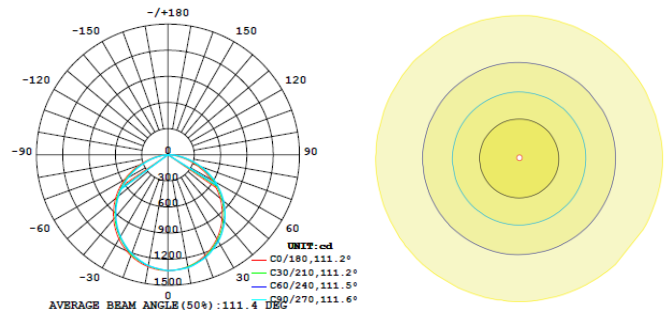

Physical Dimensions

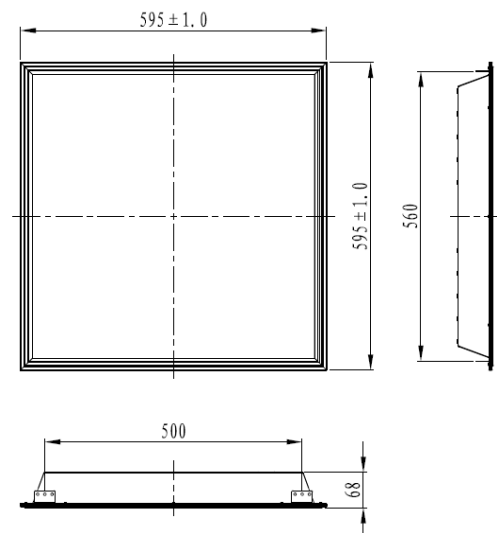

≥0.90	85 Ra	IP30	≥100000 Hrs	AC 100-240V	47-63Hz
Power Factor	CRI	IP Level	TM-21(L ₇₀)	Input Voltage	Power Frequency

Others

Power Efficiency	Working Temperature (Environment)	Heat Sink Surface Temperature
≥87%	-20 ~ +50°C	35°C (环境温度30°C)
Fixture Efficiency	Working Humidity (Environment)	Luminaire Base Temperature
≥90%	30% ~ 80%RH	51.5°C (环境温度 30°C)
Total Harmonic Distortion	Storing Condition	LED Power Consumption
≤20%	-20 ~ +65°C	35W±3W

Suitable for Shopping malls, supermarkets, hotels, offices, conference rooms, department stores, exhibition center, villas and other indoor lighting.